

Dorsey's Dynamike Model DYS groove gage combines a lightweight, compact, rigid cast frame and a patented ball bushing slide with a series of interchangeable gaging arms to suit virtually any application.

FEATURES:

- ✓ .25" (6mm) of gaging travel / retraction.
- ✓ .25" to .75" (6mm-19mm) diameter range.
- ✓ 1.25" (32mm) long precision ground adjustment rail.
- ✓ Can accommodate dial or digital indicator.
- ✓ Retraction pulls away from indicator.

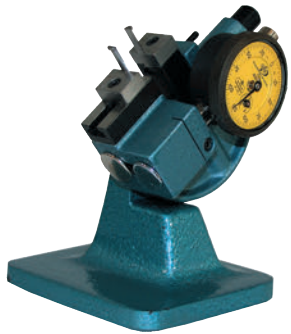

Gage shown is DYS with special metric indicator, part# 2305 arms, and part # 18967 bench stand

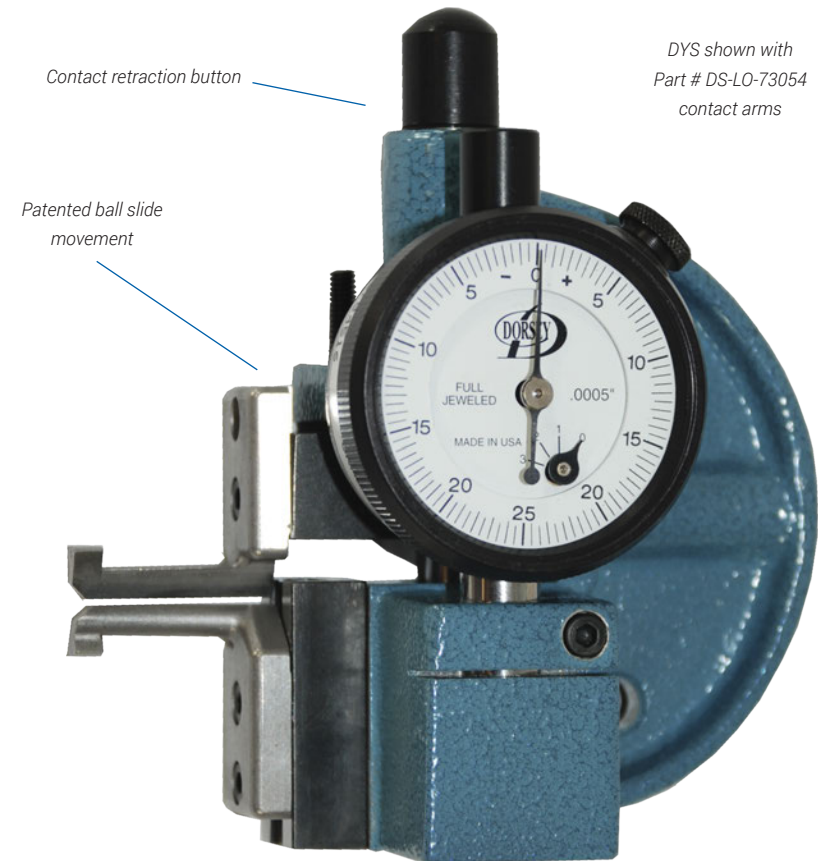
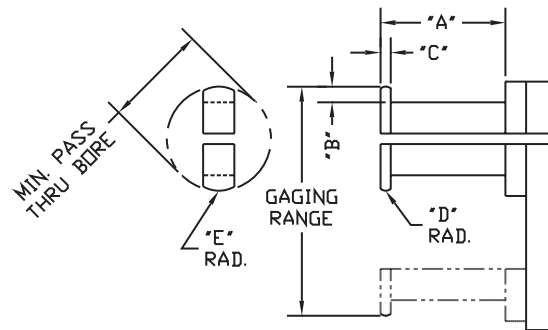

DYS shown with Part # DS-LO-73054 contact arms

Shown actual size

The DYS Groove Gage is supplied per model # below with DYS Groove Gage body, model # 1DM125-05 dial indicator, .0005" graduation, and the appropriate contact arm set for the range noted below:

PART #	RANGE	MIN / BORE	TYPE	"A" Dim.	"B" Dim.	"C" Dim.	CONTACT ARM #
DYS-250-2	.250 - .500	.187	2 Point	.500	.030	.030	# 2305-2
DYS-250-3	.250 - .500	.187	3 Point	.500	.030	.030	# 2305-3
DYS-500-2	.500 - .750	.350	2 Point	1.000	.075	.060	# 2306-2
DYS-500-3	.500 - .750	.350	3 Point	1.000	.075	.060	#2306-3
DYS-Blank*	To Suit	.370	2 Point	.750	.097	.125	# DS-LO-73054*

PART #	DESCRIPTION
DYS-FRAME	DYS Groove Gage body only, less gaging arms and indicator
18967	For the Bench Stand used with the DYS gages
2335	Clamp nut used with part # 2305 & #2306 contact arms
DS-LO-2335	Clamp nut used with part # DS-LO-73054

*Note #1: Blank contacts can be used as supplied or modified to suit a specific application.

*Note #2: For pricing on special gaging arms to suit a specific application, submit the part print with your quotation. Arms can be ordered separately.

Dorsey's Dynamike Model DYN groove gage combines a patented ball bushing slide with a series of gaging arms to suit almost any application. Gaging contact retraction is accomplished by using a conveniently mounted thumb lever while gaging range adjustment is accomplished by sliding the static gaging arm along its precision ground rail.

FEATURES:

- ✓ .500" (13mm) of gaging travel/retraction.
- ✓ .75" to 3.50" (19mm - 88mm) diameter range.
- ✓ 3" Long precision ground adjustment rail.
- ✓ Precision machined cast jig plate frame.
- ✓ Thermal isolation grips.
- ✓ Can accommodate any of Dorsey "High Amplification", "Traditional", or digital indicator.
- ✓ Retraction pulls away from indicator.
- ✓ Indicator can be rotated 360 degrees to suit any application.

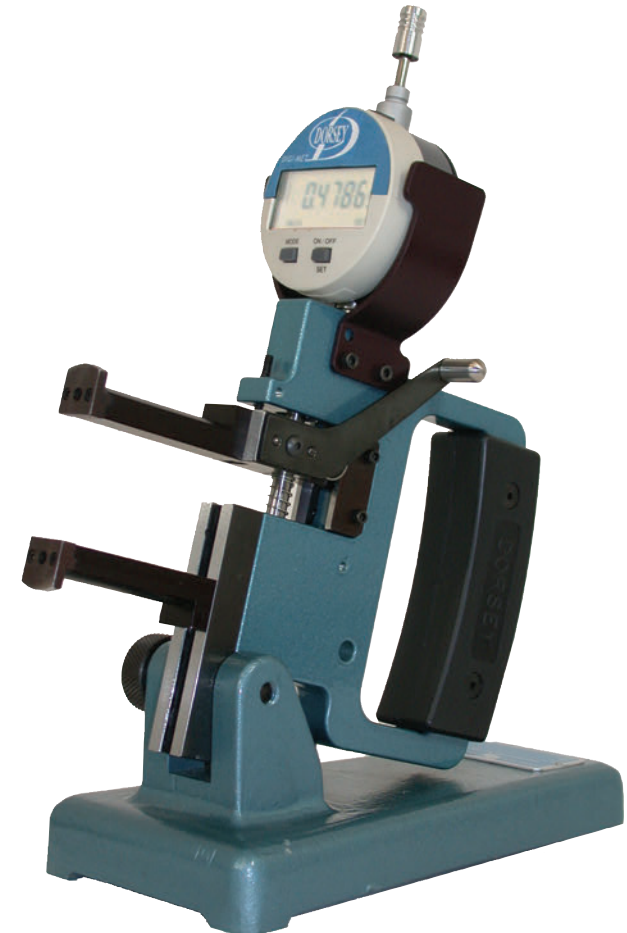
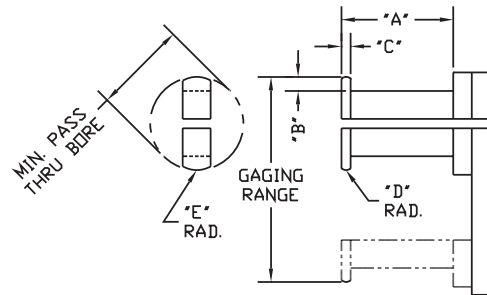

The DYN Groove Gage is supplied per model # below with DYN Groove Gage body, model # 2DM125-05 dial indicator, .0005" graduation, and the appropriate contact arm set for the range noted below.

PART #	RANGE	MIN / BORE	TYPE	"A" Dim.	"B" Dim.	"C" Dim.	CONTACT ARM #
DYN-750-2	.750 - 2.00	.500	2 Point	1.50	.125	.125	# 2405-2
DYN-750-3	.750 - 2.00	.500	3 Point	1.50	.125	.125	# 2405-3
DYN-2000-2	2.00 - 3.50	2.000	2 Point	2.00	.125	.125	# 2465-2
DYN-2000-3	2.00 - 3.50	2.000	3 Point	2.00	.125	.125	#2465-3
DYN-Blank-S*	To Suit	.370	2 Point	.750	.097	.125	# DS-LO-73054*
DYN-Blank-L*	To Suit	.850	2 Point	1.44	.206	.190	# DS-LO-73055*

PART #	DESCRIPTION
DYN-FRAME	DYN Groove Gage body only, less gaging arms and indicator
48502-S	For the Bench Stand used with the DYN gages
2335	Clamp nut used with part # 2405 & #2465 contact arms
DS-LO-2335	Clamp nut used with part # DS-LO-73054 AND # DS-LO-73055

*Note #1: Blank contacts can be used as supplied or modified to suit a specific application.

*Note #2: For pricing on special gaging arms to suit a specific application, submit the part print with your quotation. Arms can be ordered separately.

UNIVERSAL GAGE- ID/OD/LOCATION

www.dorseymetrology.com

Dorsey's universal measuring gage was designed to combine our proven patented precision linear movement with a frame that accommodates a wide variety of contacts. This gage can precisely measure various internal and external dimensions such as diameters, grooves, splines, tapers, wall thickness, counterbores, hole locations, and even threads.

FEATURES:

- ✓ Patented linear slide with 1" (25.4 mm) of gaging travel / retraction.
- ✓ Indicator can be rotated 360 degrees to suit application.
- ✓ Measurement range up to 5" ID / 2/5" OD.
- ✓ Lightweight precision machined jig plate frame.
- ✓ Can accommodate dial or digital indicators.



*Indicator sold separately

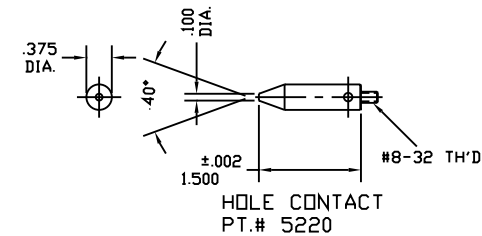
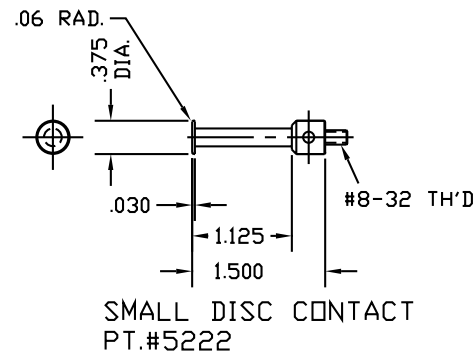
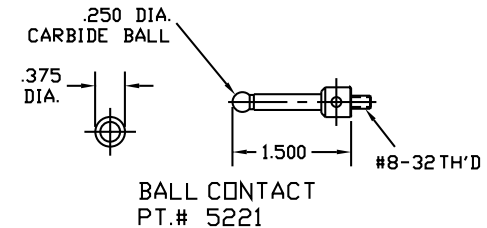
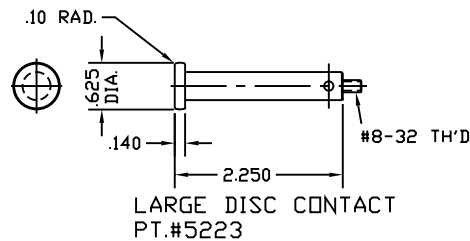

DIAMETER, LENGTH AND DEPTH CONTACT
MADE TO THE GROOVE APPLICATION

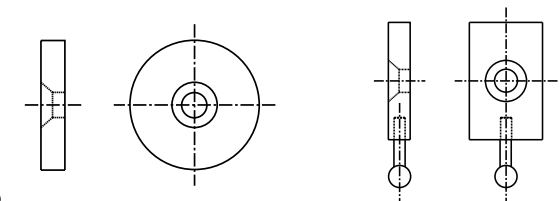
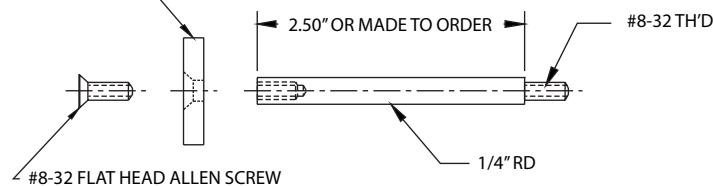

Contact designed specific to groove which can be manufactured by Dorsey for the customer, Send print part, Dorsey will help with the contact design.

MODEL	DESCRIPTION
UG-1	Universal gage complete with standard disc contact (part #5211-2)
UG-KIT	Universal gage complete with standard disc contact (part #5211-2), ball contacts (part #5213), .25" disc contacts (part #5214), digital indicator (part #F15830), and fitted storage case
48502-S	Bench Stand for UG