

# MODEL 32P HORIZONTAL BEAM

The 32P was designed with crisp, clear telecentric optics and a precision solid cast iron workstage to be an instrument capable of handling almost any inspection requirement. This welded steel fabrication assures years of accurate, trouble free service.

## FEATURES:

- 32"(800mm) Vertical screen for optimum viewing
- Erect profile image with fully corrected surface reflection image
- High resolution ground glass screen with calibration reticle, 90 degree cross lines and chart clips
- Machined chart ring with vernier protractor, 1 minute graduation
- Coated telecentric parfocal optics
- Output for electronic rotary screen protractor with selectable 1 minute or 1/100 of a degree resolution
- 3 position rotary lens & condenser turret (6 position optional)
- Quartz halogen profile light source 24V, 150W
- Bright 500W fiber optic surface illumination
- Integrated hood
- Nickel plated, completely cast iron workstage
  - Triple universal dovetails
  - 36" x 8" Overall size
  - Solid crossed roller stage system
  - 500 lbs. Capacity
  - 18" X Axis motorized adjustment
  - 10" Y Axis motorized adjustment
  - ±15 Degree true parfocal helix table adjustment, with 5 minute vernier
  - Computerized microstep motor controller with X and Y axes joystick control
- Available with internal edge sensing
- NIST traceable calibration certificate
- 2 Year limited warranty



## TECHNICAL SPECIFICATIONS

Illumination	Profile: Built-in 24V/150W direct collimated halogen
Screen size	Surface: Built-in 24V/250W via fiber optics
Workstage	16" (400mm) Ground glass with cross-lines
Workstage Travel	Cast iron, nickel plated, 18" x 5", twin dovetail
	X = 10" (250mm)
	Y = 6" (150mm)
	Focus = 2" (50mm)
	Surface: Built-in 24V/250W via fiber optics (x2)
Workstage Options	Optional increase of stage travel to 20" on X axis (500mm)
Workstage Accuracy	Within +/- 0.004mm +[(L/20).001]
Linear Scale Resolution	Standard: 0.001mm/.00005"
	Optional: 0.0005mm/.000020"
Repeatability	+/- 1 Scale count (0.001mm/.00005")
Coated Telecentric Lenses	5x, 10x, 20x, 25x, 31.25x, 50x, 62.5x, 100x
Optical Accuracy	Within +/- .10% Profile, +/- .15% Surface
Power Requirements	120V or 240V AC, 50/60 Hz, 10 Amp
Weight	460 lbs./210 kg.

## DIMENSIONS

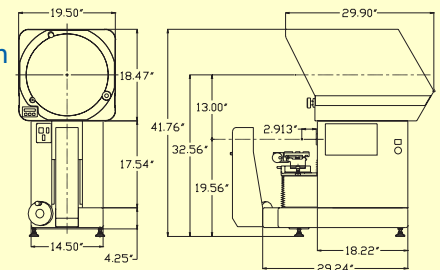

Proudly made in the USA

