

WORK STAGE TOOLING CONTINUED

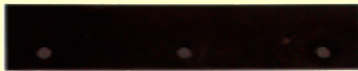

Part # ACC-BF

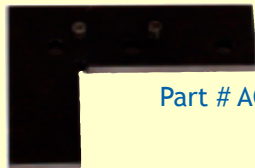

Part # ACC-LBF

FIXTURE BANKING PLATES

- Part# ACC-BF (6" x 1")
- Part# ACC-LBF (3" x 2.5")
- Precision ground steel
- Reversible for left or right bank
- Can be used on horizontal or vertical stages

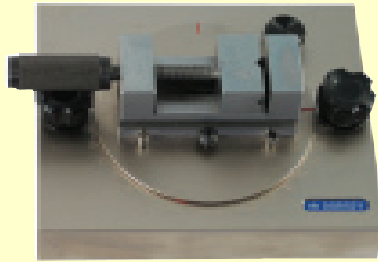

Part # ACC-RV1

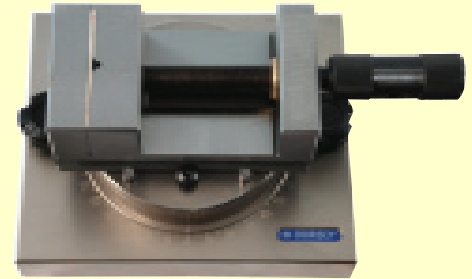

Part # ACC-RV2

ROTARY VICE STAGE

- Part# ACC-RV1 jaw opening of 1.25"
- Part# ACC-RV2 jaw opening of 2.12"
- Precision ground steel
- Positions vice in X, Y or Z axis
- 360 degree rotation with 1 degree graduation

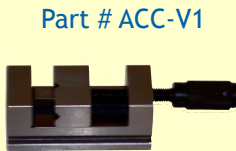

Part # ACC-V1

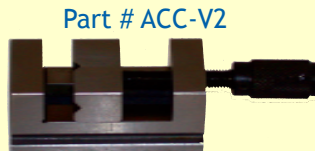

Part # ACC-V2

PRECISION FIXTURE VICE

- Part# ACC-V1 jaw opening of 1.25"
- Part# ACC-V2 jaw opening of 2.12"
- Precision ground steel
- Vertical and horizontal V



Part # ACC-VB1

PRECISION V BLOCK

- Part# ACC-VB1
- Precision V block
- Hardened and ground steel
- 90 degree V 2.7" high

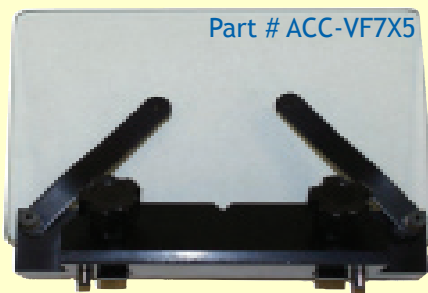

Part # ACC-VF7X5

VERTICAL GLASS FIXTURE

- Part# ACC-VF7x5
- Used to mount flat parts on horizontal comparators
- 7" x 5" glass
- 2 Chart clips & V

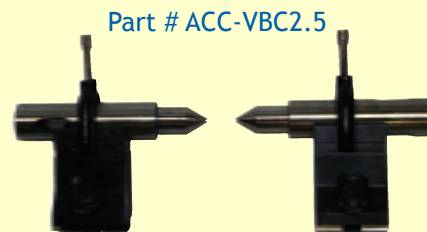

Part # ACC-VBC2.5

PRECISION V BLOCK & CENTER KIT

- Part# ACC-VBC2.5
- Matched ground hardened steel
- 90 degree V
- 2.7" tall
- 1" diameter centers with interchangeable Morse taper insert

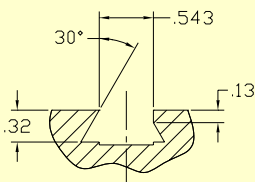

Typical universal dove tail detail used on all horizontal staging

Proudly made in the USA

