

# LONG RANGE SNAP GAGE OPTIONS

Dorsey's long range snap gages feature .50" / .12mm of gaging travel and are used to replace many fixed disc setmasters. This option can be fitted to either the SDN or SSG series frame.

## SDN STYLE

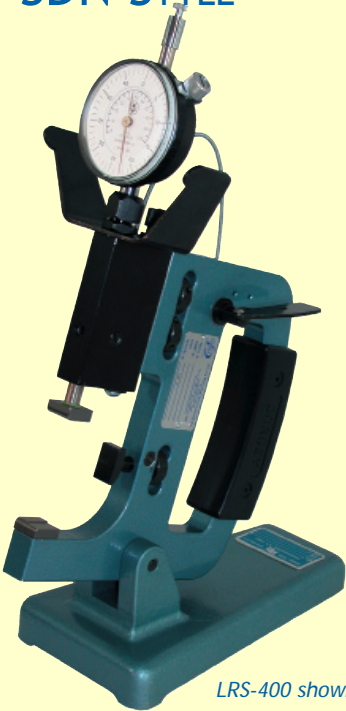

LRS-400 shown on a bench stand

SDN FRAME		SSG FRAME
PART #	RANGE	PART #
LRS-00	0 - 1"	LRS-15371
LRS-100	.5 - 2"	LRS-15372
LRS-200	1.5 - 3"	LRS-15373
LRS-300	2.5 - 4"	LRS-15374
LRS-400	3.5 - 5"	LRS-15375
LRS-500	4.5 - 6"	LRS-15376
LRS-600	5.5 - 7"	LRS-15377
LRS-700	6.5 - 8"	LRS-15378
LRS-800	7.5 - 9"	LRS-15379
	8.5 - 10"	LRS-15380
	9.5 - 11"	LRS-15381
	10.5 - 12"	LRS-15382
	11.5 - 13"	LRS-15383
	12.5 - 14"	LRS-15384
	13.5 - 15"	LRS-15385
	14.5 - 16"	LRS-15386
	15.5 - 17"	LRS-15387
	16.5 - 18"	LRS-15388

\*Indicator sold separately

## SSG STYLE



LRS-15377 shown

# SNAP GAGE OPTIONS

The following options can be specified on either the SSG or SDN series snap gages.

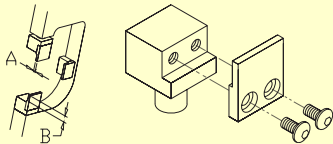

INTERCHANGABLE BLADE ANVILS		
PART #	A DIM.	B DIM.
2274-1	.040" (1mm)	.08
2274-2	.060" (1.5mm)	.12
2274-3	.080" (2mm)	.16
2274-4	.100" (2.5mm)	.20
2274-5	.125" (3.2mm)	.31
2274-6	.156" (4mm)	.31
2274-7	.187" (4.7mm)	.31

(RIGHT) Self centering form anvils  
Applications include measurement of major diameter or thread form

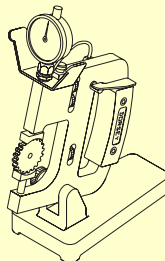

## PITCH DIAMETER GEAR AND SPLINE CONTACTS

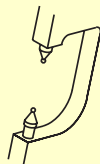

**Fixed ball or roll contacts**  
Can be used in conjunction with side stops to check pitch diameter of helical gears

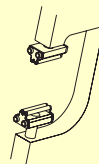

**2 wire or 3 wire self aligning floating rolls on interchangeable carriers**  
Best suited for pitch diameter measurement on threads, screw forms, helical gears and splines

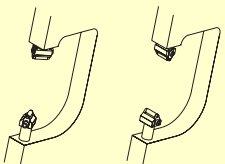

**2 Wire or 3 wire floating carbide rolls on fixed carriers (plus special master)**  
Best suited for heavy production inspection of pitch diameter on threads, screw forms, helical gears and splines

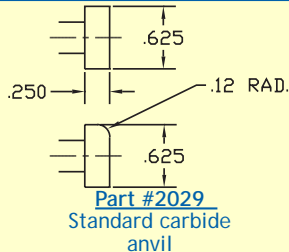

SDN Series frame shown with interchangeable floating rolls, thumb retraction, and bench stand (part #48502) designed to check pitch diameter of a triple start worm gear.



Proudly made in the USA

