

EASY BORE SERIES (2 OR 3 POINT RETRACTABLE HOLE GAGES)

INDIVIDUAL GAGE SELECTION GUIDE

1) Select measurement head size

.236" - .394" HEAD
F20312 - F20313

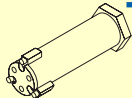

.395" TO .629" HEAD
F20314 - F20315

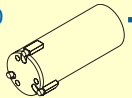

.630" - .787" HEAD
F20316

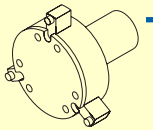

.787" - 1.023" HEAD
F20317

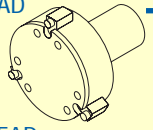

1.023" - 7.874" HEAD
F20318 - F20335

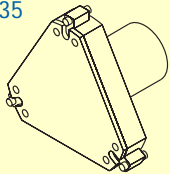

2) Determine if extension is required

F20345

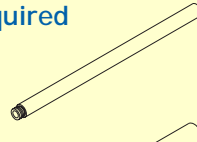

F20346

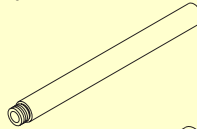

F20347

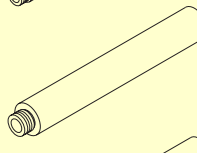

F20348

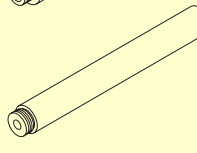

F20349

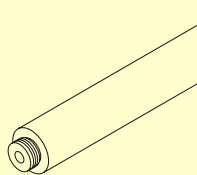

3) Select pistol grip or lever grip handle

F20310



F20308

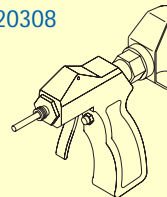

F20311

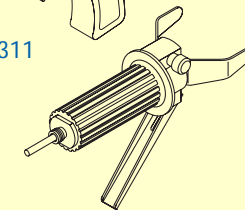

F20309

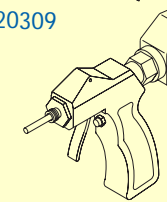

4) Select an indicating device

ELECTRONIC PROBE

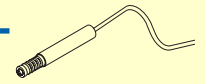

DIAL INDICATOR 1" TRAVEL

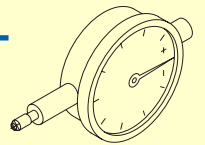

DIGITAL INDICATOR 1" TRAVEL

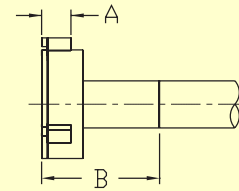
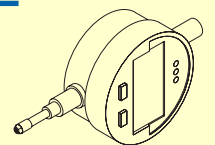

HEAD PART #	HEAD SIZE		LINE A INCH	LINE B INCH
	MM	INCH		
F20312	6-8	.236-.315	.109	2.36
F20313	8-10	.315-.394	.118	2.36
F20314	10-13	.394-.511	.157	2.36
F20315	13-16	.511-.630	.236	2.36
F20316	16-20	.630-.787	.295	2.36
F20317	20-26	.787-1.023	.433	2.36
F20318	26-32	1.023-1.260	.433	2.36
F20319	32-40	1.260-1.575	.433	2.75
F20320	40-50	1.575-1.968	.591	2.75
F20321	50-60	1.968-2.362	.591	2.75
F20322	60-70	2.362-2.756	.591	2.75
F20323	70-80	2.756-3.150	.591	2.75
F20324	80-90	3.150-3.543	.591	2.75
F20325	90-100	3.543-3.937	.591	2.75
F20326	100-110	3.937-4.330	.767	2.75
F20327	110-120	4.330-4.724	.767	2.75
F20328	120-130	4.724-5.118	.767	2.75
F20329	130-140	5.118-5.512	.767	2.75
F20330	140-150	5.512-5.906	.767	2.75
F20331	150-160	5.906-6.299	.767	2.75
F20332	160-170	6.299-6.693	.866	2.75
F20333	170-180	6.693-7.087	.866	2.75
F20334	180-190	7.087-7.480	.866	2.75
F203	190-200	7.480-7.874	.866	2.75

MASTER SETTINGS BILATERAL CLASS	
PART #	INCH
F21162	.2912
F21164	.3437
F21167	.3475
F21172	.5025
F21177	.7187
F21185	.9062
F21191	1.0312
F21205	1.4062
F21450	1.75
F21451	2.1875
F21452	2.5625
F21453	2.9375
F21454	3.3437
F21455	3.75
F21456	4.125
F21457	4.5625
F21458	4.9062
F21459	5.3125
F21460	5.7187
F21461	6.1093
F21462	6.5
F21463	6.9062
F21464	7.2912
F21465	7.6875

PART #	PISTOL GRIP & LEVER HANDLE DESCRIPTION
F20308	Pistol grip for .236" - .629" diameter
F20309	Pistol grip for .630" - .787" diameter
F20310	Lever grip for .236" - .629" diameter
F20311	Lever grip for .630" - .787" diameter

EXTENSIONS FOR LONGER DEPTHS			
PART #	GAGE HEAD	METRIC	INCH
F20345	F20312 - F20313	100mm	3.937"
F20346	F20314 - F20315	100mm	3.937"
F20347	F20316	100mm	3.937"
F20348	F20317	150mm	5.905"
F20349	F20318 - 20335	150mm	5.905"
F20338	Adapter for Bowlers/Fowler head		
F20337	Adapter for Mitutoyo Borematic		

PART #	OPTIONS DESCRIPTION
F20336	Stand for pistol grip bore gage
EBGI	Ultra protective housing for pistol grip

PART #	FITTED STORAGE CASE DESCRIPTION
F80524	Pistol grip head and master 16-40mm
F80525	Pistol grip head and master 41-60mm
F80526	Pistol grip head and master 61-80mm
F80527	Pistol grip head and master 81-100mm



Dorsey Metrology International
Website: www.dorseymetrology.com

Proudly made in the USA



Tel: (845) 454-3111 Fax: (845) 454-3888
53 Oakley Street, Poughkeepsie, NY 12601