

INTERNAL PITCH DIAMETER BORE GAGE

The Internal Pitch Diameter gage is ideally suited to check the internal pitch diameter of gears and splines. It can also be used to check any internal dimension where centralization is not necessary. Production models are available for a specific "best wire size" dimension. Models over 1.25" are supplied with interchangeable screw-in contacts. Special Fixed "V" masters are available to suit the application.

FEATURES:

- Carbide ball contacts (best wire size)
- Interchangeable screw in contacts
- Can be used to check PD or major root diameter of gears and splines
- Optional fitted storage case available

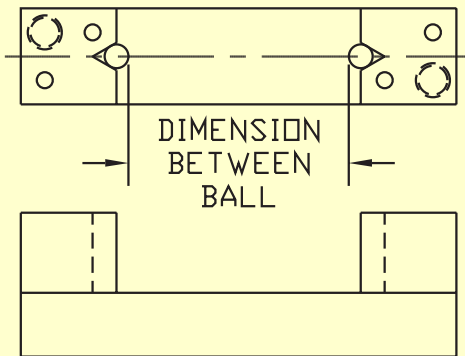
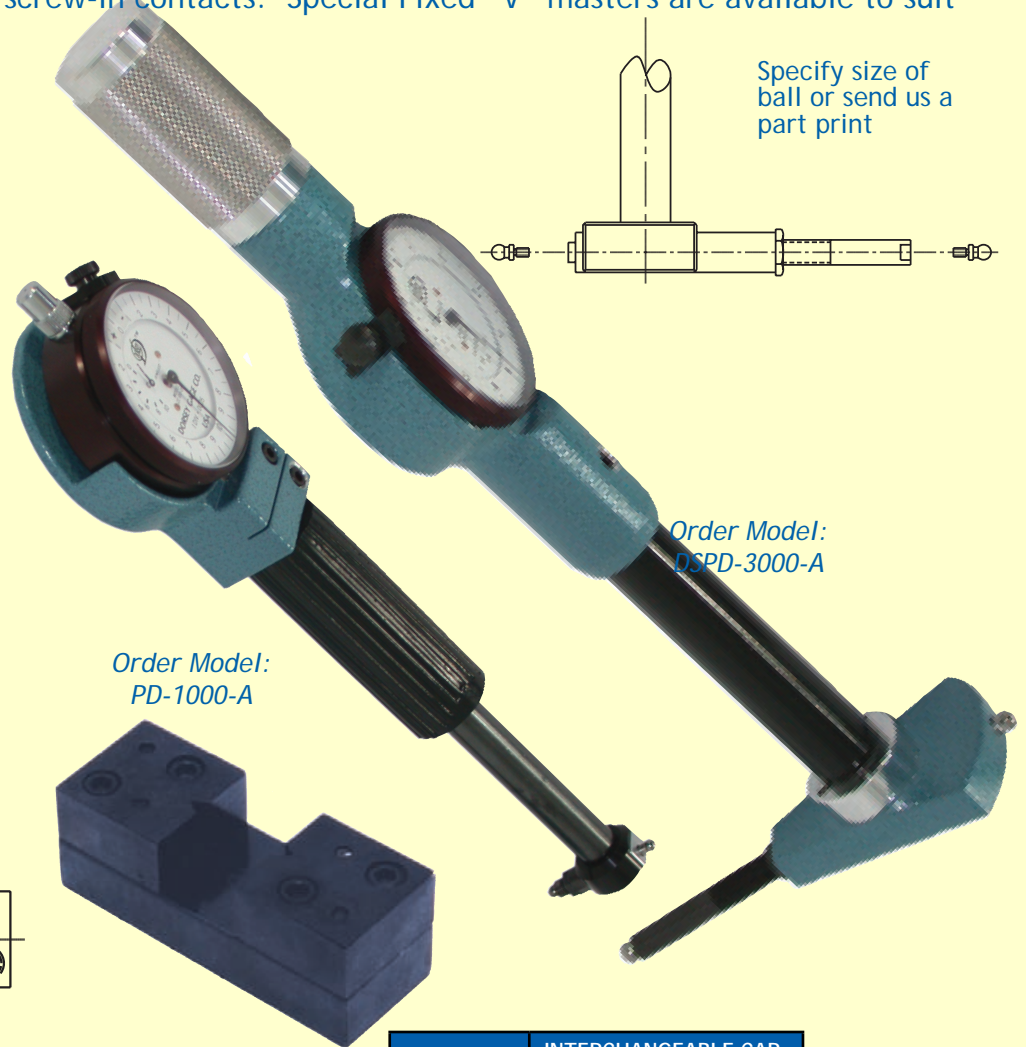

INTERCHANGEABLE CARBIDE CONTACTS	
PART #	DIAMETER
.1250"	4081-125B
.1875"	4082-187B
.2500"	4082-250B
SPECIALS QUOTED PER APPLICATION	

PART #	CONTACT TYPE	GAGING DEPTH (INCHES)	BOTTOM OF HEAD TO CENTERLINE OF CONTACT	FRAME STYLE	BETWEEN BALL/ROLL DIMENSION	STORAGE BOX PART #
PD-500	FIXED	3"	.188"	DBL-499	.50" - 1.25"	9000
DSPD-1000-A	INTERCHANGEABLE	5"	.224"	DS # 3	1.25" - 3.00"	DX2-89953
PD-1000-A	INTERCHANGEABLE	4"	.188"	DBL-998	1.25" - 3.00"	9000
DSPD-3000-A	INTERCHANGEABLE	6"	.224"	DS # 5	3.0" - 6.0"	DX2-89955
PD-3000-A	INTERCHANGEABLE	5"	.250"	DBL-300	3.0" - 6.0"	9005
DSPD-6000-A	INTERCHANGEABLE	6"	.312"	DS # 6	6.0" - 13.0"	DX2-89956

* Indicator sold separately, see section A

Proudly made in the USA

